



JFK Bridge Maintenance Project

On JFK Causeway over the GIWW



October 19, 2021

History of Bridge



- Year Built: 1973 (48 years old)
- Previous Maintenance:
 - Added Concrete Median Barrier (1979)
 - Added Pier Protection/Dolphins (2011)
- Current AADT: 29,380 (2013)
- Major Gateway between Padre Island and Corpus Christi/Flour Bluff





- **Location:** At Intersection of GIWW Bridge on JFK Causeway
- **Length:** 0.62 miles
- **Purpose:** Structural repairs and bridge preservation on PR 22 by:
 - Repairing various concrete spalls/damage
 - Replacing various superstructure components (bearing pads, bridge joints, etc.)
 - Concrete Deck overlay
- **Total Cost:** \$8.7 million
- **Duration:** 346 working days (19 mo.)
- **Traffic Impacts:** Lanes reduced to one lane in each direction

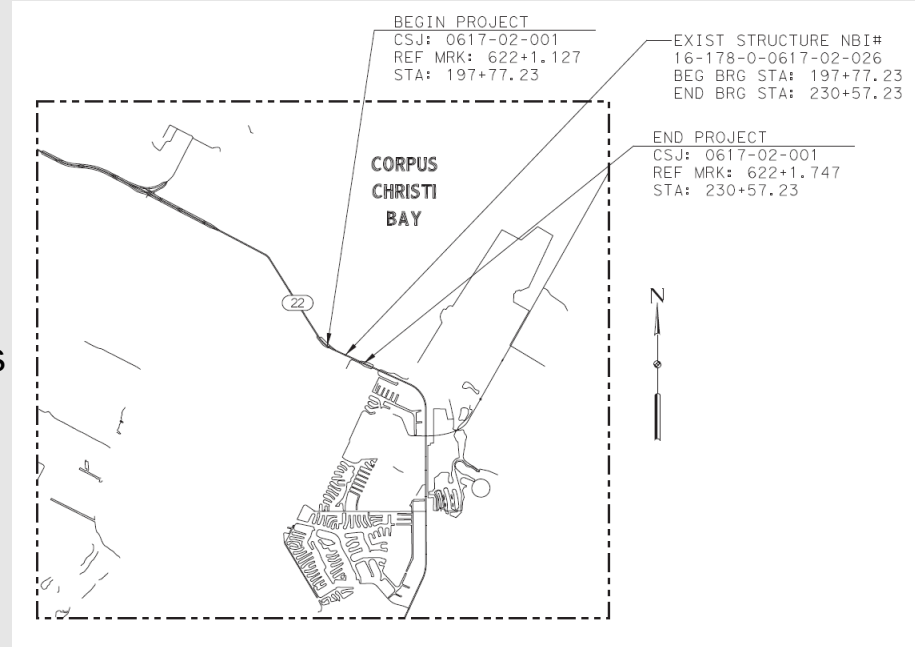



Long Term (December to May)

- Eastbound closures only allowed during October to May
- Westbound closures only allowed during December to May
- Westbound closures not allowed during Hurricane Season from June to November.
- Between Memorial Day and Labor Day, Single Lane Closures only allowed Mon-Thur and all lanes must be open Fri-Sun
- No lane closures allowed during Beach to Bay Marathon (May 21, 2022) or Conquer the Coast event (TBD)

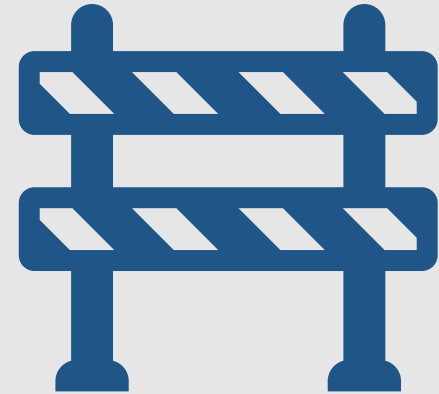



Short Term (June to November)

- Westbound lane closures allowed from 9am – 5pm
- Eastbound lane closures allowed from 8am – 4pm
- Total roadway/bridge closures allowed Mon – Thu nights between 10pm – 4am (6 hr window)
 - Closures to only last 30 min max to release traffic que
 - Contractor to allow emergency response vehicles during closures
 - TCP will utilize Portable Traffic Signal

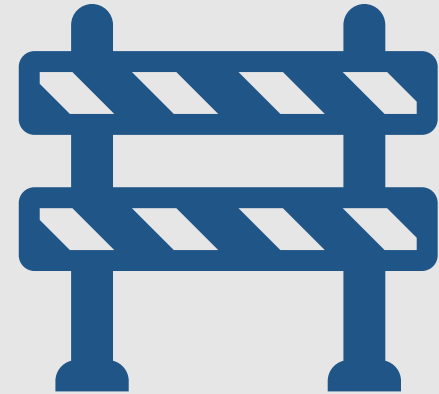

PR 22 Existing Bridge Section

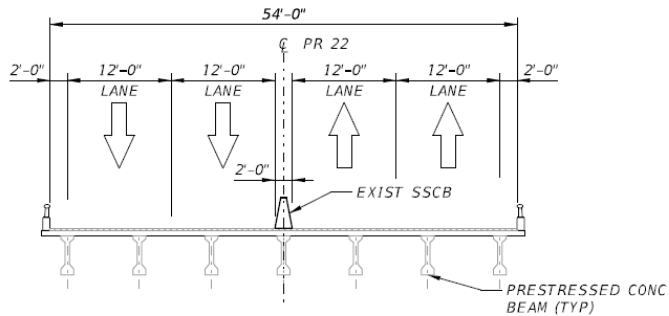

UNITS 1-6 & 8-13 TYPICAL SECTION

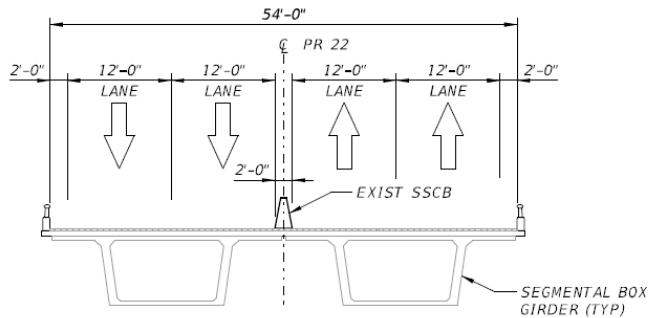

UNIT 7 TYPICAL SECTION

EXIST & FINAL CONDITION



PR 22 Phase 1 - 3 Bridge Section

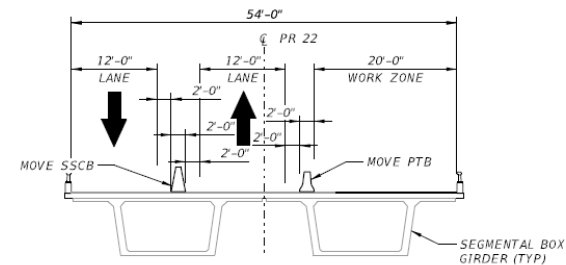
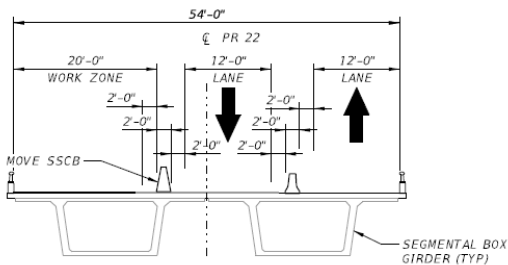
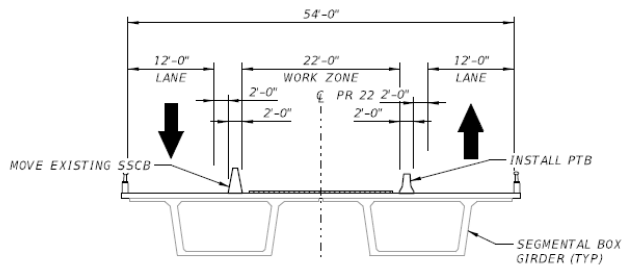
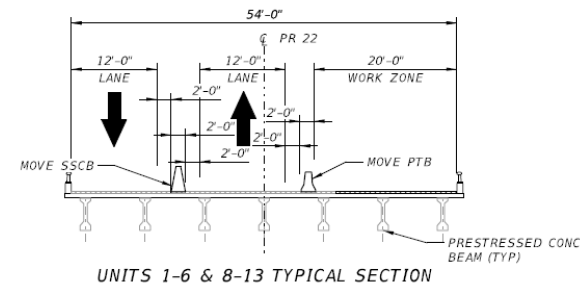
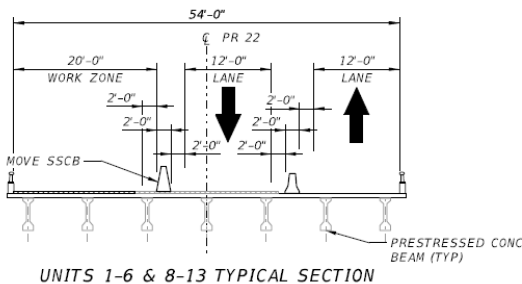
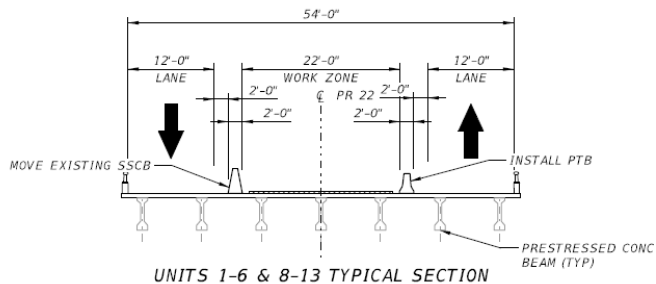

TRAFFIC CONTROL PHASE 1

TRAFFIC CONTROL PHASE 2

TRAFFIC CONTROL PHASE 3



Primary Construction Activities:

- Replacement of existing bridge armor joints
- Planing operations and polyester polymer overlay on bridge segmental unit spans
- Multilayer polymer overlay on bridge approach spans



Anticipated Traffic Impacts:

- Shift PR 22 EB/WB mainlane traffic to the outside lanes
- Mainlane traffic reduced to one lane on both EB and WB travel ways.
- * Some temporary nighttime mainlane closures from 10 p.m. to 4 a.m.
- * One lane in each direction to always be maintained outside of the nighttime closures



Primary Construction Activities:

- Replacement of existing bridge armor joints
- Planing operations and polyester polymer overlay on bridge segmental unit spans
- Multilayer polymer overlay on bridge approach spans



Anticipated Traffic Impacts:

- Shift PR 22 EB/WB mainlane traffic to the south side of existing bridge
- One lane on both EB and WB travel ways to be maintained.
- * Some temporary nighttime mainlane closures from 10 p.m. to 4 a.m.
- * One lane in each direction to always be maintained outside of the nighttime closures



Primary Construction Activities:

- Replacement of existing bridge armor joints
- Planing operations and polyester polymer overlay on bridge segmental unit spans
- Multilayer polymer overlay on bridge approach spans



Anticipated Traffic Impacts:

- Shift PR 22 EB/WB mainlane traffic to the north side of existing bridge
- One lane on both EB and WB travel ways to be maintained.
- * Some temporary nighttime mainlane closures from 10 p.m. to 4 a.m.
- * One lane in each direction to always be maintained outside of the nighttime closures



- **Project Construction Management:** Texas Department of Transportation (TxDOT)
- **Contractor:** Gibson & Associates, Inc.
 - Headquarters in Dallas (Balch Springs, Texas)
 - Local project field office



GIBSON &
ASSOCIATES, INC.
Engineers & Contractors



Initial Anticipated Timeline:

- Barricades Set: 3rd week of November '21
- Work Start Date: 1st week of December '21
- Initial Traffic Switch: TBD, expected in December '21



Project Contacts:

- TxDOT:
 - Ernest Longoria, P.E., Corpus Christi Area Engineer: 361-808-2322
 - Rickey Dailey, Public Information Officer: 361-808-2544
- Gibson & Associates, INC:
 - Project Superintendent: Steve Baker